



promineo

How to register bugs and improvements

ILAP Data Exchange Testing Kick-Off

May 11th, 2023

What is a Bug (in the context of software)?

Bug

When the Software does not perform as **intended by design**



Improvement

When the Software does not behave or perform the way you think it should.



Report both!

Try to categorize in “Bug” or “Improvement”

It can sometimes be hard to tell the difference. Do not worry!

Remember: The purpose of testing is finding bugs. Finding and reporting bugs = Success!

Repro Steps

Reproduction steps

To fix the bug, we need to be able to reproduce it.

When you find a bug, try to reproduce it, more than once.

Then document how the bug can be reproduced using screen captures and text.

Bug Report ILAP DataExchange from External Tester	
Tester name:	Leif Arild Åsheim
Tester organization:	Promineo
Date:	11.04.23
Repro Steps Text:	I go Setup>Templates and click the +New Template button. Then specify a few lines and try to save the Template WITHOUT adding a Title. See message in the lower right corner:

The screenshot shows a web application interface for creating a template. At the top, there is a navigation bar with links for 'Active IEAs', 'Inactive IEAs', 'Setup', 'Tenant Admin', and 'System Admin'. Below the navigation bar, there is a form for creating a template. The form includes a text input field for 'Type template title...', a button for '+', and a label for '# of fields: 0'. Below the form, there is a table with columns for 'Planning Object Type', 'Field Code', 'Description', 'Data Type', 'Content Control', and '# of values'. The table contains three rows of data:

Planning Object Type	Field Code	Description	Data Type	Content Control	# of values
Activity	Disc	The discipline code associated with the activity. E.g: E=Ele...	SByte	System	0
Activity	WBS	The Work Breakdown Structure that the activity is part of. ...	SByte	Tenant	0
Activity	Phase	The phase code associated with the activity. E.g: K=Engin...	SByte	System	0

At the bottom of the form, there are two buttons: 'Cancel' and 'Save Changes'. In the bottom right corner of the screenshot, there is a red error message that says 'Invalid request model'.

Screen Capturing Error Messages

Error messages are only displayed for a limited amount of time

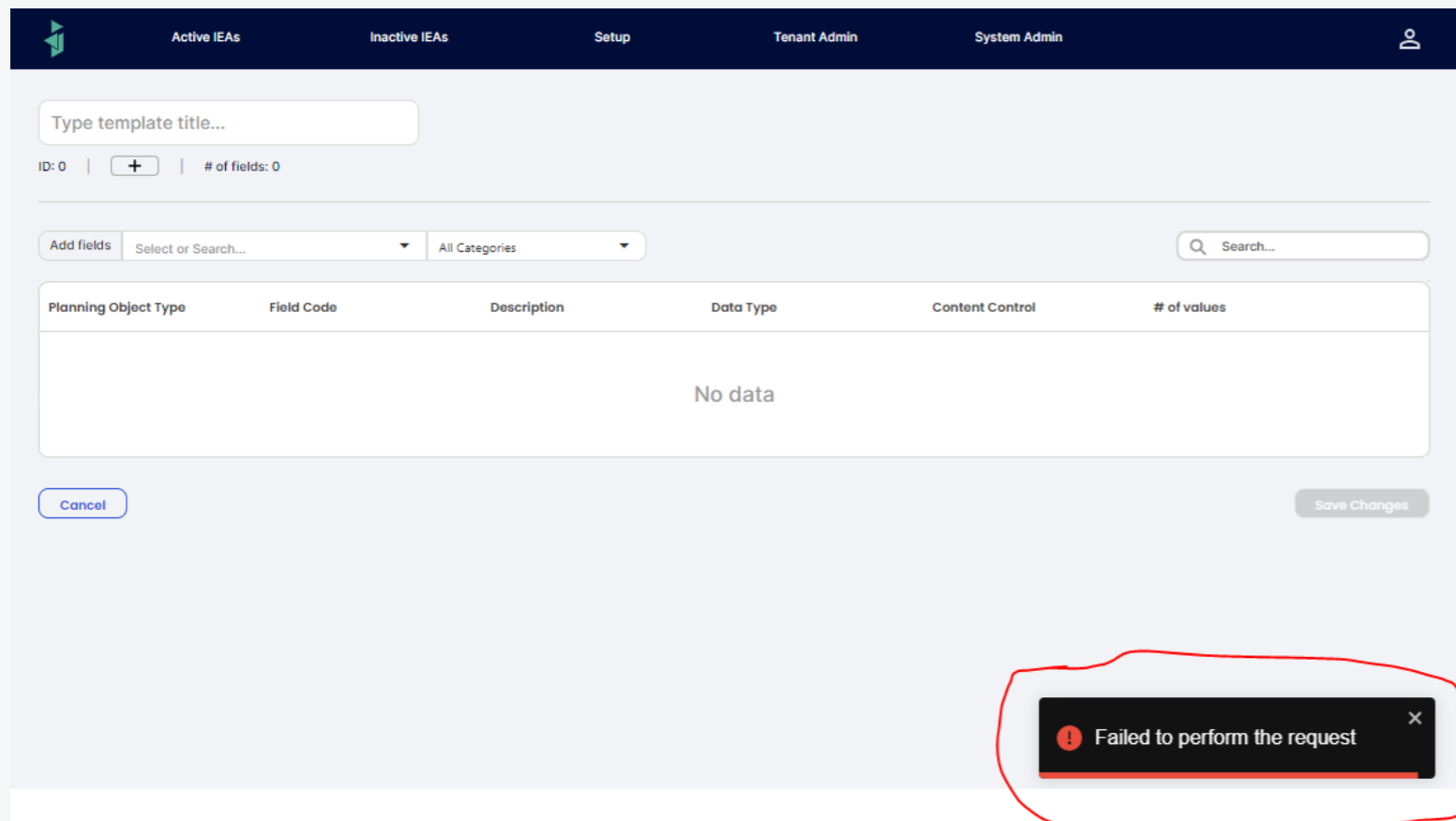

Set delay to 3 seconds in Snipping Tool to capture:

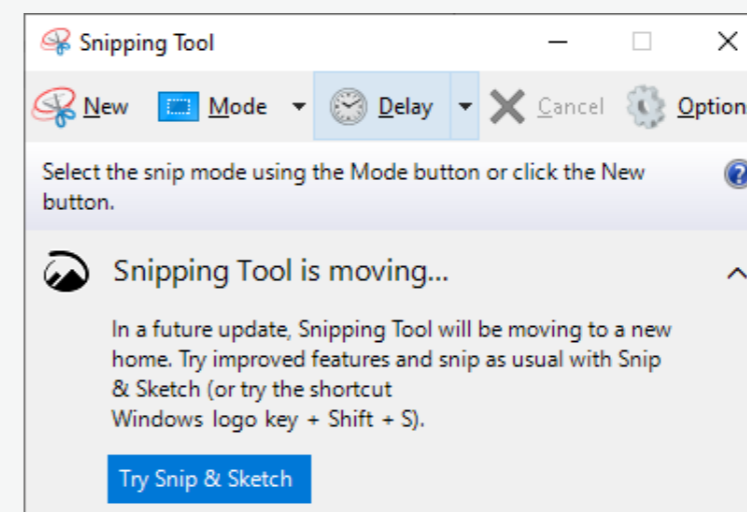

What else to know?

Use the English language

We are an international team, and most of us do not master the Norwegian language.

A prepared spreadsheet and reporting guidelines will be distributed

Use the spreadsheet to document.

Use the guideline to remember all you forgot from this presentation

Send your reports to robsk@equinor.com at the earliest opportunity



What happens after you report?

Did you find it first?

If so, registered in our project management system: DevOps

If not, it is already in the pipeline being processed

New bugs are reviewed once or twice a week

1 – Hotfix, resolve as soon as possible so the fix can be published in the next version

2 – Fix during next sprint, published in the version after next

3 – Fix at a later time

We aim to distribute bugfix reports so you can track progress.

Improvements

Registered as User Stories in DevOps and prioritized against all other work

No further feedback



Happy Hunting!

